

BAUCO[®] XL

Extra-large, hinged, virtually invisible, access panel



BAUCO® XL

Extra-large, hinged, virtually invisible, access panel

DESCRIPTION

BAUCO® XL is a drywall access panel with concealed hardware, extra rugged frame, solid finishing bead, and proprietary fixed hinge. The door is designed for large yet functional access openings (primarily in walls) that blend seamlessly with the surrounding finishes. The door hinges via a virtual pivot-point, which minimizes the potential for mechanical damage to the leading edges. The door leaf can easily be removed for clear access. The BAUCO® XL is available in standard sizes starting from 24" x 36" to almost any custom size (inquire!).

BAUCO XL COMPARED TO BAUCO plus II

- Box-style frame fastens to studs
- Integrated finishing bead
- Fully hinged door swings left or right in walls
- Larger size of single door leaf in walls (up to 22 sq.ft)

APPLICATIONS

- The BAUCO XL is designed for large access openings in walls (ceilings possible)
- The front-mounted frame with bead can be used in any guage or drywall
- New construction or retro-fitting, without reframing and re-boarding of rough openings
- Non fire-rated assemblies

BENEFITS

- Virtually invisible, fully customizble, access openings
- Minimal 2mm (5/64") visible reveal
- Door leaf with concealed hinge swings open to 105 degrees
- No shadow gaps due to recessed or proud installation
- Apply your treatments across surface for continuous finish
- Superior acoustics with gasket + mass of GWB in door (STC tested)
- Custom sizes, custom inlays, and custom hardware

MATCH YOUR DESIGN

The concealed hardware, variety of inlay's, and flush finishes allow for a variety of surface treatments. Finishing (by others): paint, plaster, stucco, tile, wall coverings, veneer and millwork.

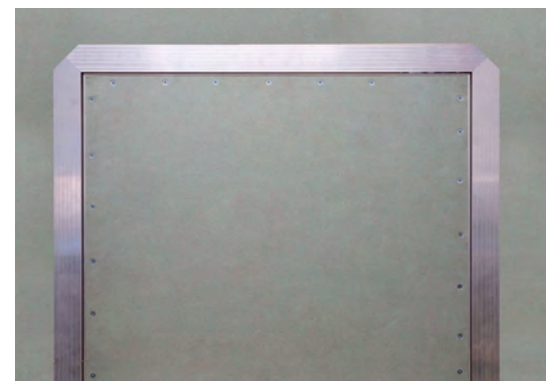

BAUCO® XL

Extra-large, hinged, virtually invisible, access panel

STANDARD FEATURES

- Heavy-duty aluminum frame with finishing bead
- Countersunk holes in frame for flush front mounting
- Easily unhinged / removable door leaf with concealed steel hardware
- Perimeter gasket made of closed-cell foam-filled rubber
- Moisture and mold resistant drywall inlay

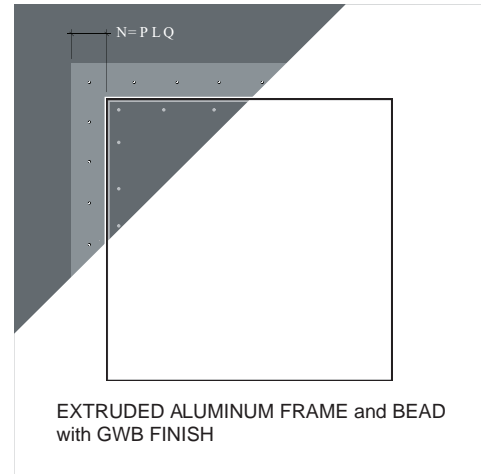

IMPERIAL/METRIC SIZE CHART FOR STANDARD SIZES (NOMINAL DOOR)

Model Number	Access Door Size inch (mm)	Minimum Rough Opening	Weight (lbs)
40-W-2436-TL	24" x 36" (609.6 x 914.4)	25 1/4" x 37 1/4" (645 x 950)	22.5
40-W-3636-TL	36" x 36" (914.4 x 914.4)	37 1/4" x 37 1/4" (950 x 950)	33.8
40-W-2448-TL	24" x 48" (609.6 x 1219.2)	25 1/4" x 49 1/4" (645 x 1255)	30.0
40-W-4848-TL	48" x 48" (1912.2 x 1912.2)	49 1/4" x 49 1/4" (1255 x 1255)	60.0
40-W-3060-TL	30" x 60" (762 x 1524)	31 1/4" x 61 1/4" (798 x 1560)	46.9
40-W-3072-TL	30" x 72" (762 x 1828.8)	31 1/4" x 73 1/4" (798 x 1864)	56.3

*Door leaf inlay is 5/8" GWB TL = Mechanical Touch Latch (Standard) K = Keyed Lock (Optional) CAM = Cam latch (Optional)

- Rough openings are nominal door size plus 1 1/4".
- Overall product with bead measures nominal door width/height plus 3 1/2".

CUSTOM SIZES & OPTIONS

- Custom sizes with short lead times. Larger openings with two leaves. Single leaf up to 22 sq ft
- Adjust the size and shape
- Option of two hinged leaves (bombay style without centre bar)
- Latch (concealed, cam, tamper-resistant, or keyed)
- Customize your inlay (wood, acoustic board, tile backer, etc.)
- Paint-ready option. The panels are shipped with a highly durable, factory-primed door leaf that reduces installation time.

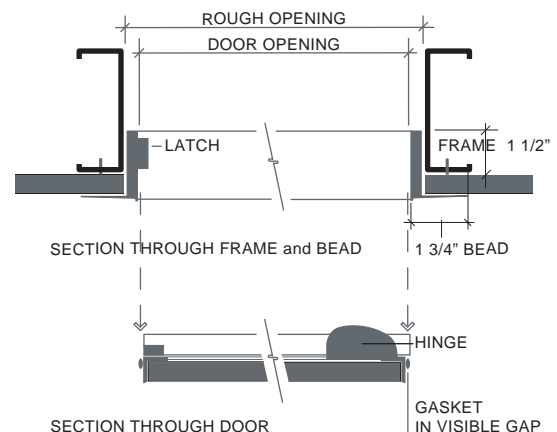

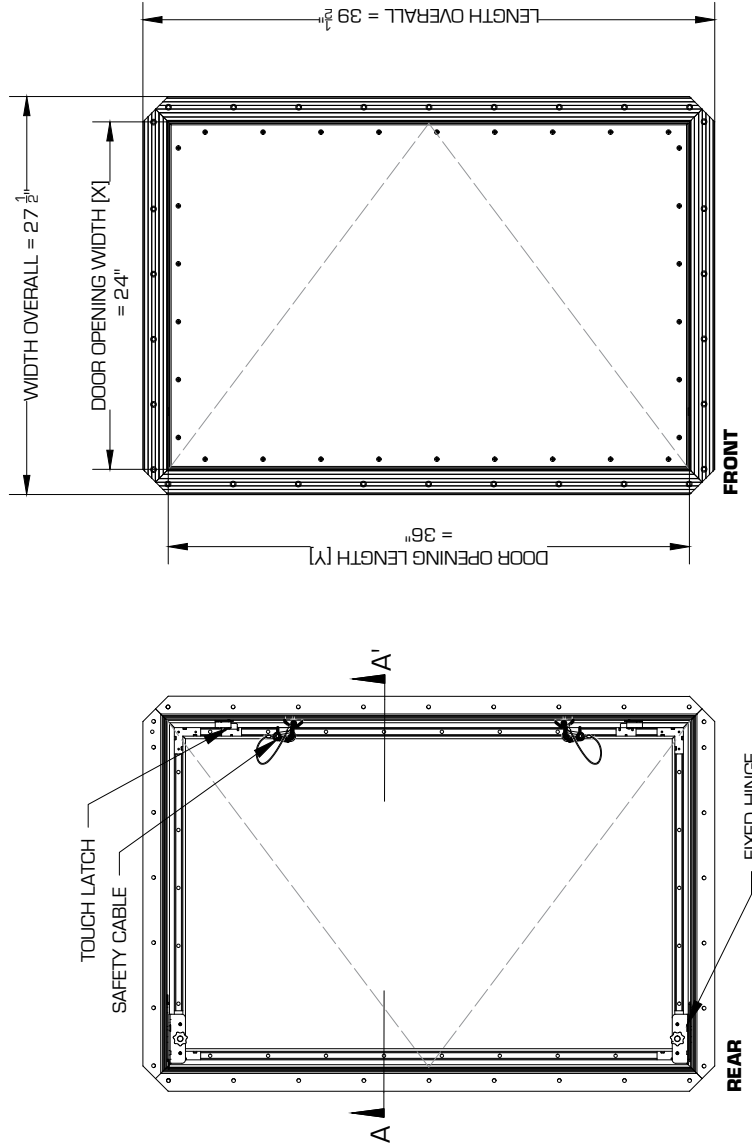

BAUCO XL ACCESS PANEL WITH FIXED HINGE AND FINISHING BEAD FOR USE IN

- ASSEMBLIES CLAD IN GYPSUM WALL BOARD AND SIMILAR SHEETING
- ALL THICKNESSES OF SHEETING
- PRIMARILY DESIGNED FOR LARGER OPENINGS IN WALLS - CEILINGS POSSIBLE. (SEE ALSO BAUCO PLUS II)
- NEW CONSTRUCTION OR REPAIRS
- EXISTING ROUGH OPENINGS
- NON FIRE RATED ASSEMBLIES

STANDARD FEATURES

- CONCEALED HARDWARE AND FRAME
- HEAVY DUTY OUTER FRAME WITH INTEGRATED FINISHING BEAD
- LEFT OR RIGHT SWINGING HINGE
- COUNTERSUNK HOLES IN FRAME FOR FLUSH MOUNTING TO SURROUNDING ASSEMBLY
- EASILY DETACHED REMOVABLE DOOR LEAF WITH CONCEALED HARDWARE
- NYLON COATED SPRING SNAP CARABINEER SAFETY CABLE

ACOUSTICS AND SEAL

- STC TESTED AGAINST ASTM E90
- ACOUSTIC BOARD INLAY AVAILABLE
- SUPERIOR RESISTANCE TO AIR LEAKAGE PER ASTM E283

MATERIALS

- ALUMINUM EXTRUDED FRAME AND FINISHING BEAD
- HEAVY GAUGE GALVANIZED STEEL HARDWARE
- CLOSED CELL FOAM FILLED RUBBER GASKET
- MOLD AND MOISTURE RESISTANT GYPSUM WALLBOARD, TYPE X 5/8" (15.9 mm)
- VINYL SAFETY CAPS

HINGE

- HEAVY DUTY GALVANIZED STEEL HINGE
- OPENS TO 105 DEGREES
- DEMOUNTABLE DOOR LEAF WITH HAND FASTENING KNOBS
- VARIABLE PIVOT POINT

LATCH

- CONCEALED MECHANICAL TOUCH LATCH
- OPTIONAL KEYS LOCK
- OPTIONAL CAM LATCH (SLOT OR TORX HEAD)

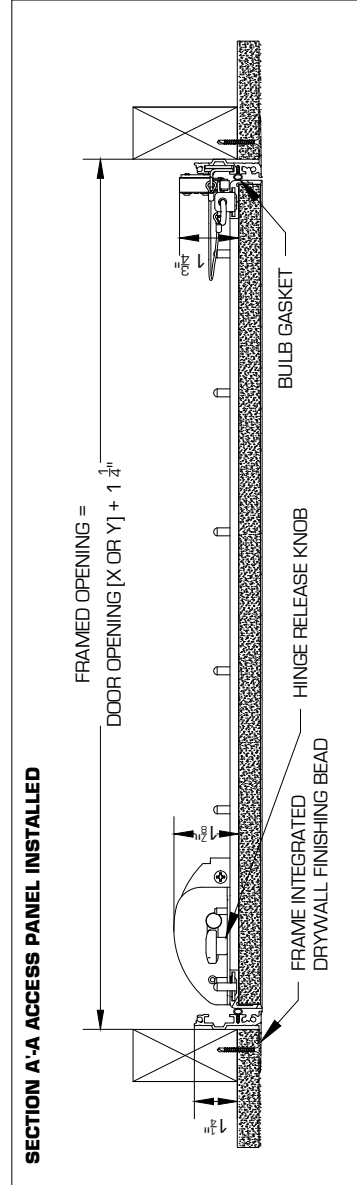

BAUCO XL ARCHITECTURAL ACCESS PANEL WITH CONCEALED HARDWARE AND GYPSUM BOARD INLAY

APPROVED BY

PROJECT NAME

8234 DEVONSHIRE ROAD VICTORIA,
BRITISH COLUMBIA CANADA V8A 4T4
P - 250.592.0033 / TF - 877.592.0033
F - 250.595.0513 / TF - 877.592.7587
W - www.accesspanelsolutions.com
E - info@accesspanelsolutions.com



DATE

CLIENT

Step 1: Prepare the Rough Opening

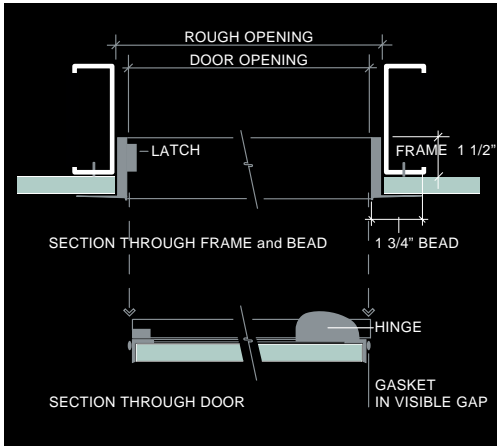

RO Dimension = Door Size + 1 1/4"

For Example: Access Panel 60" tall x 30" wide in wall, the R.O must be 61 1/4" tall x 31 1/4" wide.

- Ensure the framing is square, level and plumb.

(Fig. 1)

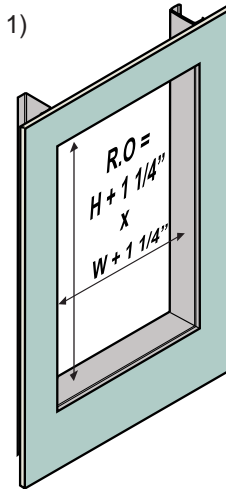

Step 2: Position, Align and Secure in R.O

- Place the closed access panel into the R.O to test the fit.
- Door can be used for either left or right swing.
- Take care not to strip the fastener hole in the framing.
- Start by placing the first fastener a top end of the side opposite the hinge (latch side (A) Fig.3) Then align that edge to be plumb and secure it from top to bottom with fasteners.
- Next lift lower end of the hinge side (Fig.3) until visible gap (---) looks evenly spaced (2mm or 5/64") all around and fix with first fastener on hinge side. Then place fasteners all along hinge side.
- Finish by placing fasteners in all holes at top and bottom of opening.
- Open door leaf and check for smooth function.

*Finishing bead should sit snug/tight against drywall.

Important Notes:

- Install fasteners to all countersunk holes
- Re-tighten all fasteners in a 2nd pass as needed

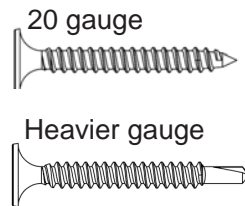

(Fig. 2)

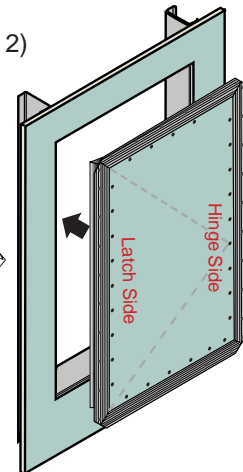

(Fig. 3)

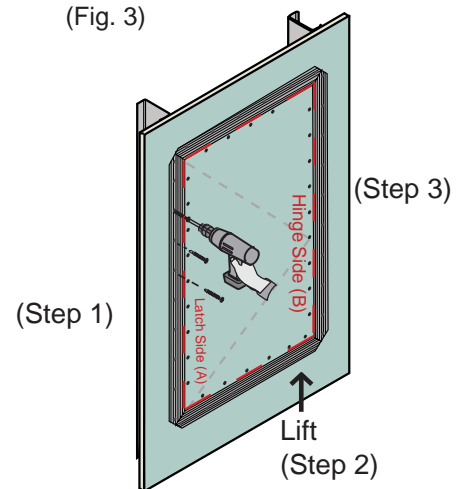

Step 4: Remove Door Leaf for Finishing

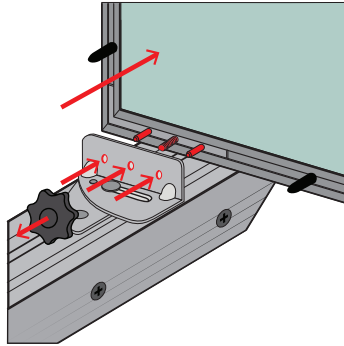

(Fig. 5)

- Open door leaf and locate black knobs at top and bottom hinge. (Fig. 4)
- Loosen the black knobs and carefully disengage the door leaf from the hinge. (Fig. 5)

(Fig. 4)

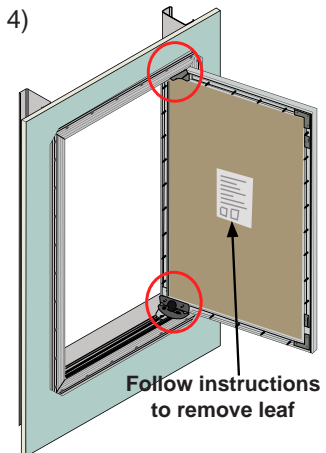

(Fig. 6)

Step 5: Apply Filler Compound to Outer Frame

- Apply a first coat of drywall compound to the bead. A setting-type compound is recommended for the first coat.
- Note that it is not necessary to tape the transition from the aluminum bead to the drywall.
- Let dry, sand, and apply more coats of filler until the desired finish is achieved. (Fig. 6)
- Apply drywall compound to the door leaf. Do not leave compound above the leading edge of the frame.
- Let dry, sand and apply subsequent coats of filler until the desired finish is achieved.

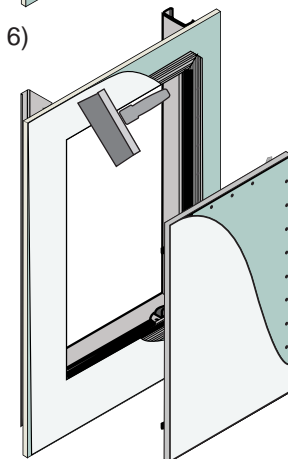

Step 6: Clean Frame and Gasket

- Use a wet cloth or gentle sanding sponge to remove any excess mud from aluminum door frame, gasket, and door leaf.
- Tip: Apply silicon lubricant to the gasket for superior operation.

(Fig. 7)

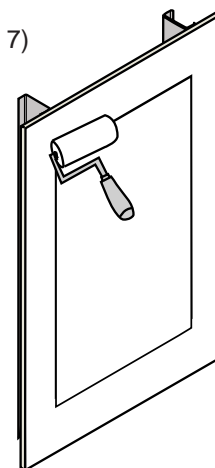

Step 7: Re-hang Door Leaf and Paint

- Reinstalling the door leaf to the outer frame is the reverse of the removal. Simply position the locating pins of the door leaf into the hinges and fasten the threaded knobs.
- Paint surface with short haired roller (Fig. 7). Avoid filling visible gap (2mm) with paint.